

This Drawing is the Property of Vaughan Harmon Systems Limited Copyright © Vaughan Harmon Systems Ltd 1998-2001 All Rights Reserved
It is supplied for identification, maintenance engineering evaluation or inspection purposes only and shall not be duplicated or disclosed without explicit written permission.

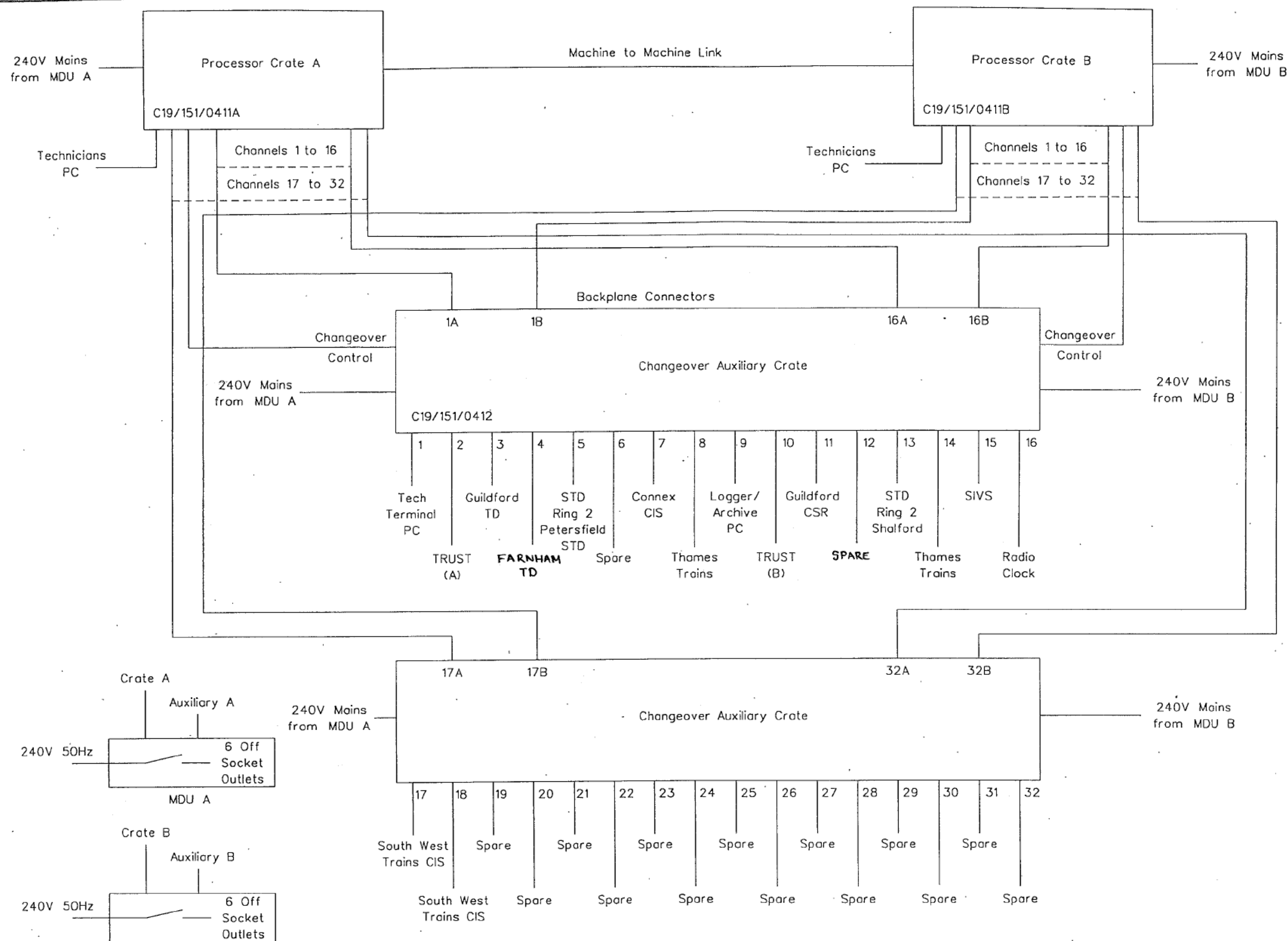

RAILTRACK

SIEMENS PLC

Siemens Transportation Systems Limited
Sopers Lane, Poole, Dorset.
BH17 7ER

ISS 2	NEW	CN25165C000 implemented		
ISS 1	17.09.98	Initial Issue		
DATE	DESCRIPTION			

MATERIAL: N/A

FINISH: N/A

TOLERANCE: N/A

ORIGINAL SCALE: N.T.S

All dimensions in millimetres unless otherwise specified

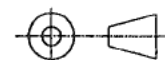

ISSUE: **ER1**

DATE: **28.4.14**

DRN:

CHKD:

APP:

**VAUGHAN
Harmon**

Vaughan Harmon Systems Limited
The Maltings, Hoe Lane, Ware,
Hertfordshire, SG12 9LR
Telephone 01920-443300
Telefax 01920-460702

TITLE:

CSR T.D. FACILITIES
Guildford
Concentrator Cubicle
System Block Diagram

DRG. NO.

G22/070

SHT. 1 OF 1

FORMERLY: